

INSTALLATION INSTRUCTIONS

(* Instructions suitable for following vehicles:

TOYOTA Hilux N70 50", Hilux N70 42".
HOLDEN RG Colorado 42" only)

To view Instalation Video go to:

<https://youtu.be/vrEuLhzZ920>

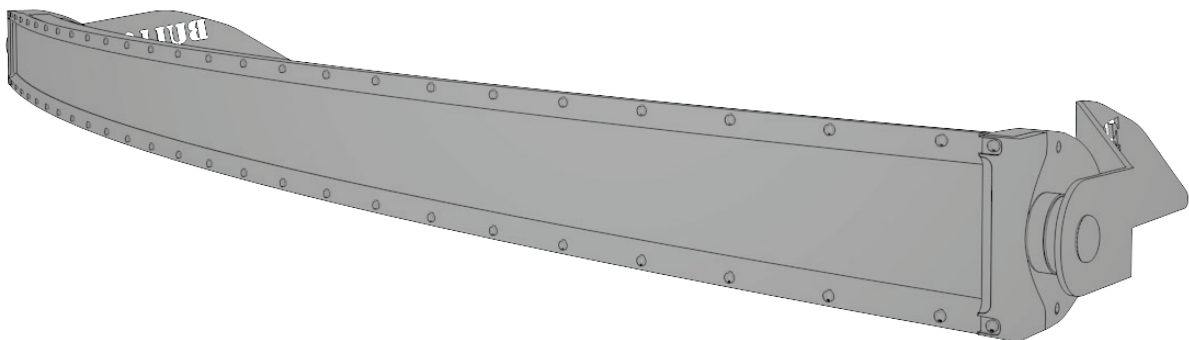

www.bullseyeproducts.com.au



Document created by Anchor Digital
www.anchor-digital.com.au

STEP 1

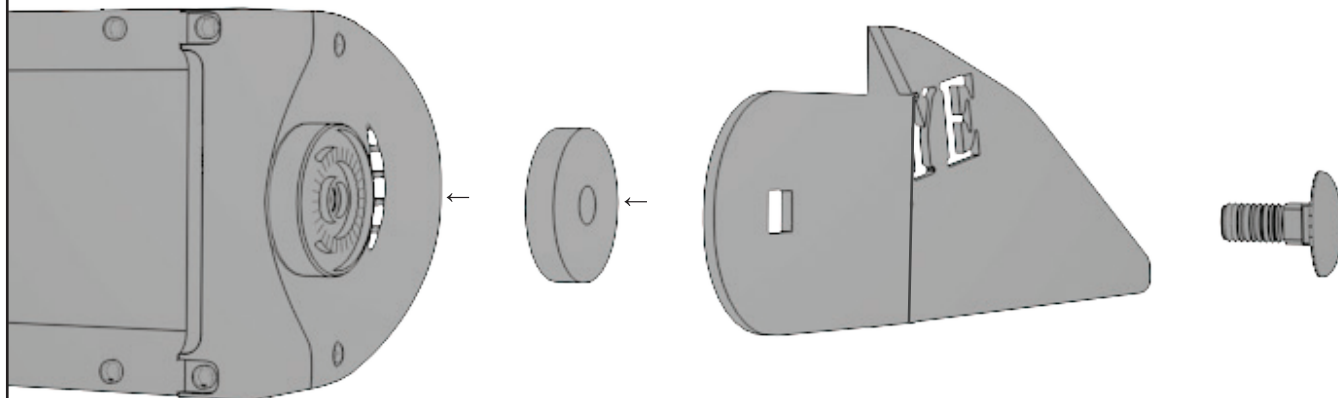

Wind the mounts onto the ends of the light bar, using the 8mm cup head bolts and rubber washers provided.

STEP 2

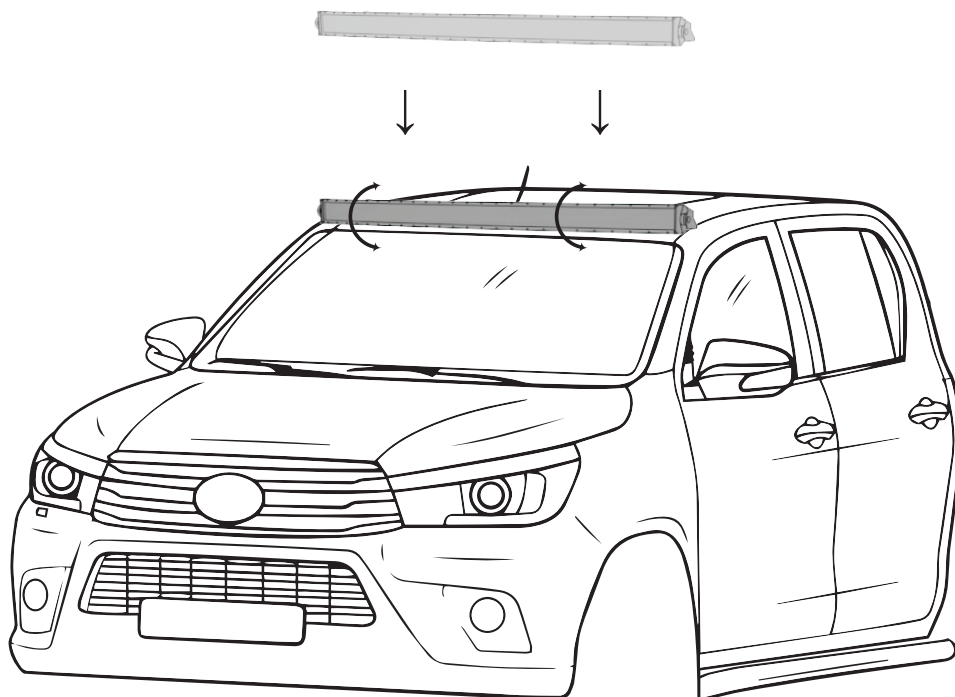

Place light bar into position on top of the windscreen, you will need a spare set of hands to help you hold it up there. Adjust the light to sit horizontally.

STEP 3

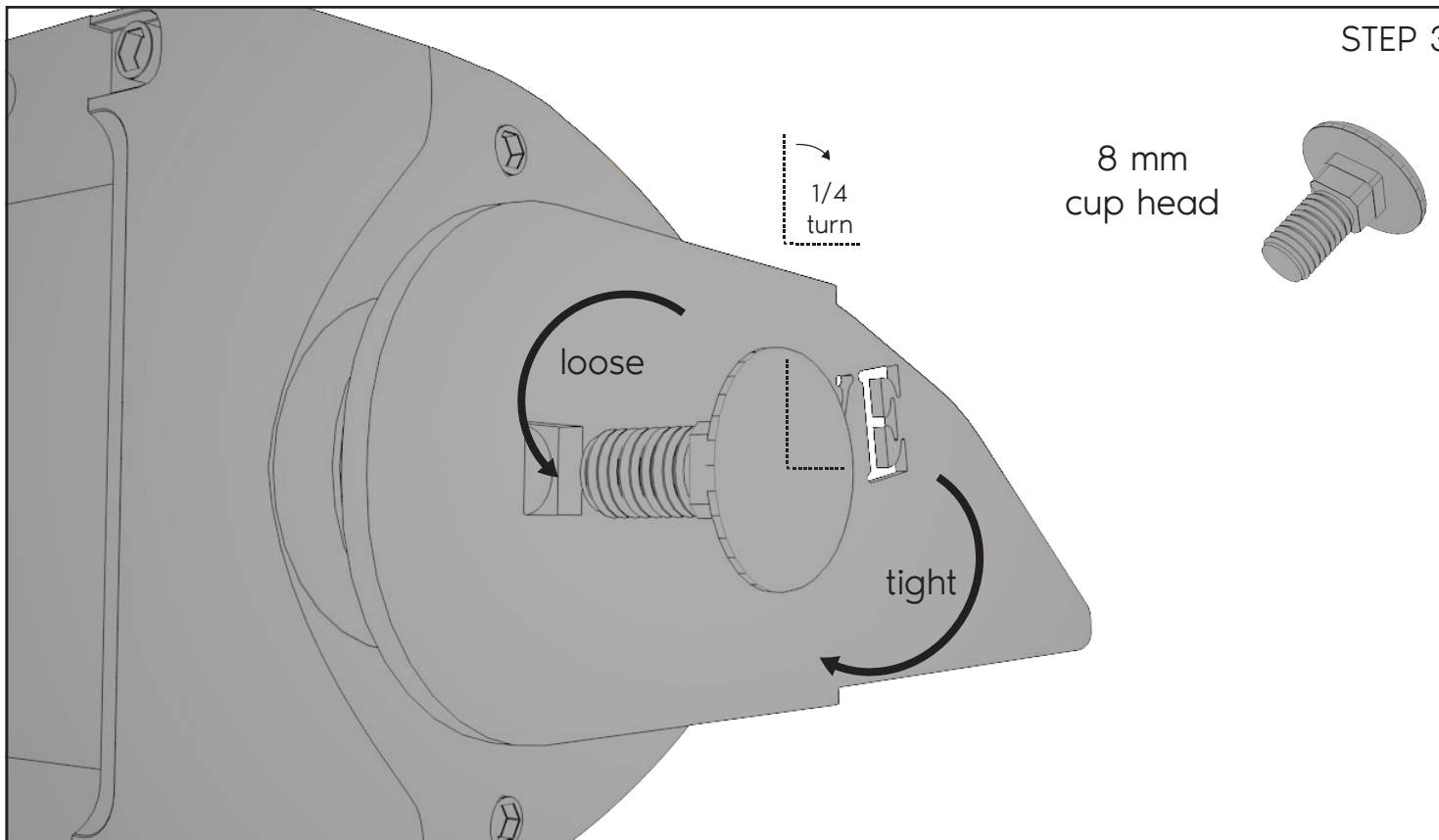

To adjust the Light bar, unwind the mount and turn bolt 1/4 clockwise or anti-clockwise in the square hole and refit it to the light bar.

STEP 4

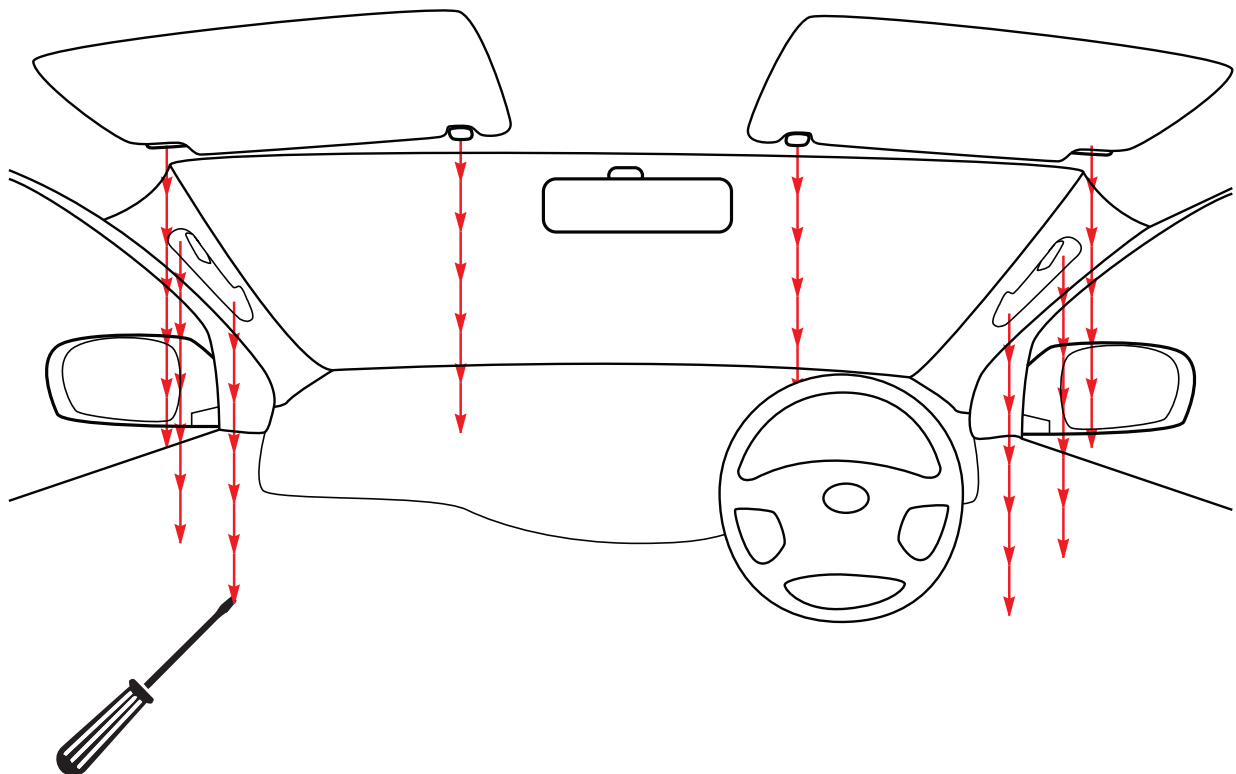

You will need to drop the roof lining on the driver's and passenger's corners.

STEP 5



*Tip: Pre-drill holes first with 6mm drill bit and then use 8 - 8.5 mm.
When drilling use drill depth stop

* align the back of the lightbar with the top of your windscreen rubber.

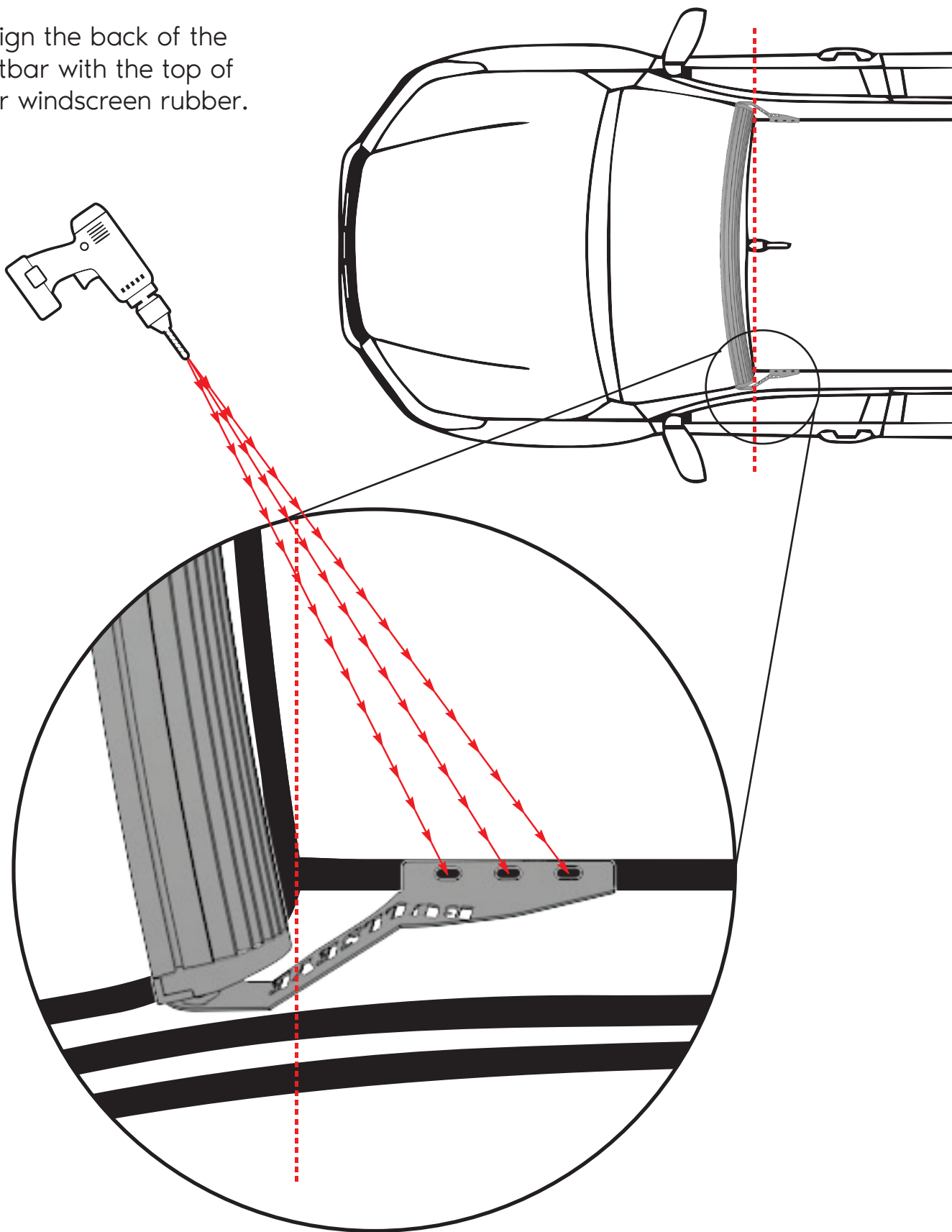

Once the lightbar in the correct position, mark and drill the holes required (8 - 8.5 mm). After drilling undercoat any bare metal.

STEP 6

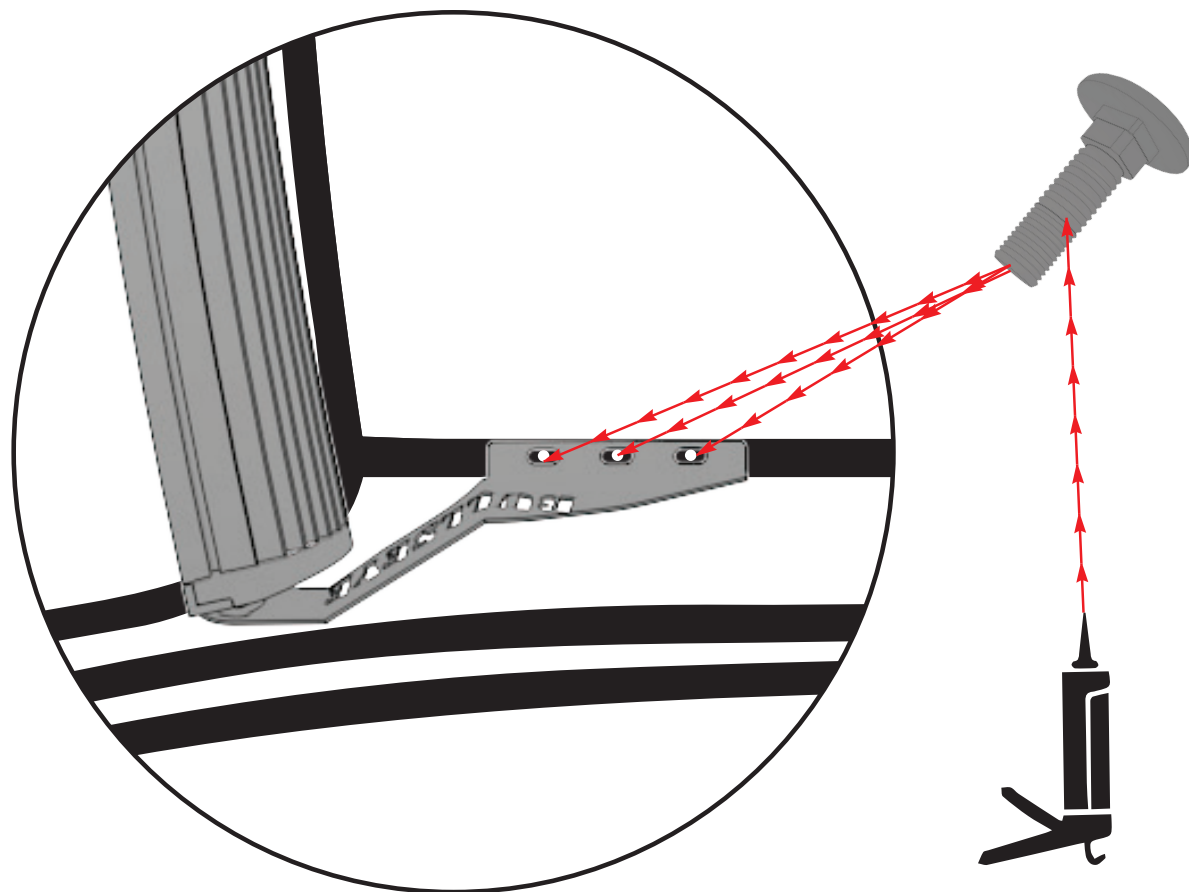

Silicone around the bolt threads, then place the Cup Head bolts into the drilled holes.

STEP 7

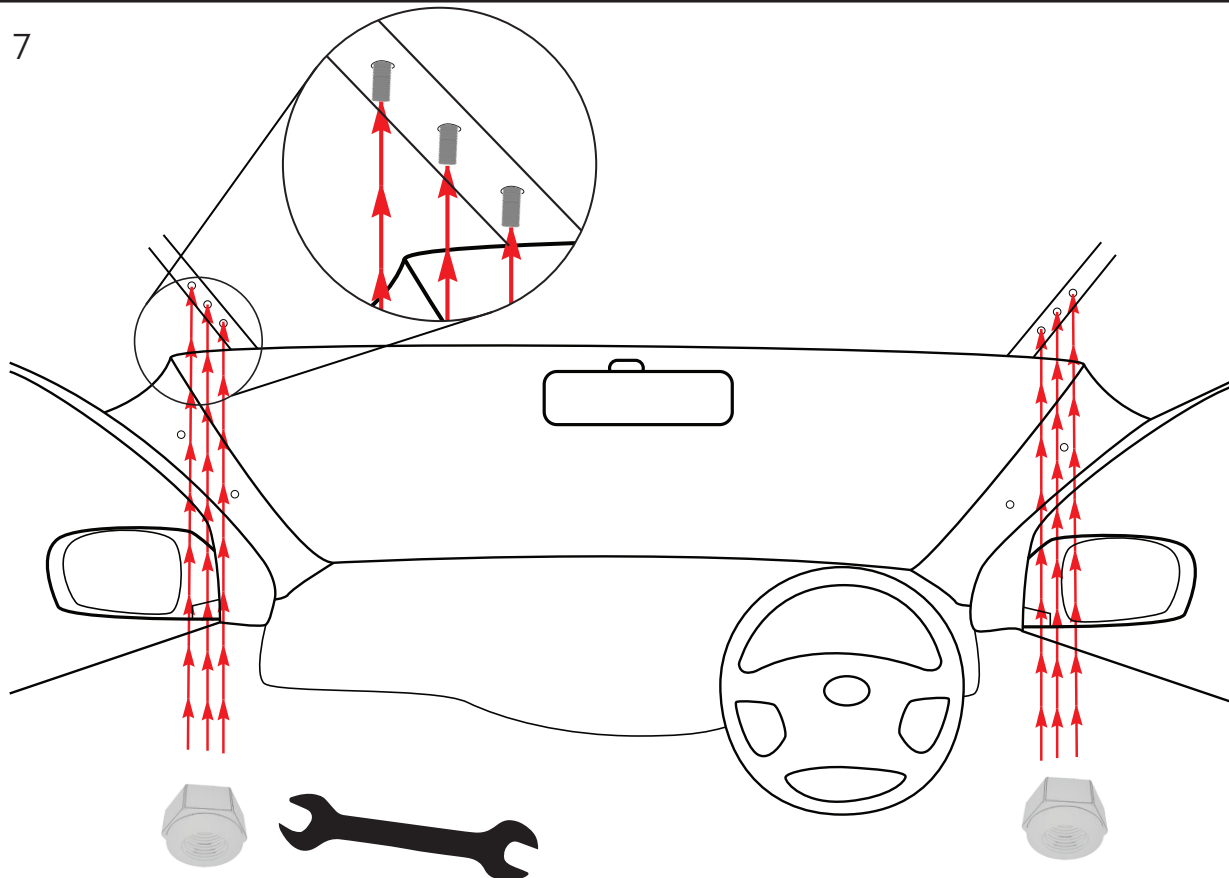

Using washers & Nyloc Nuts firmly tighten bolts in place.

STEP 8

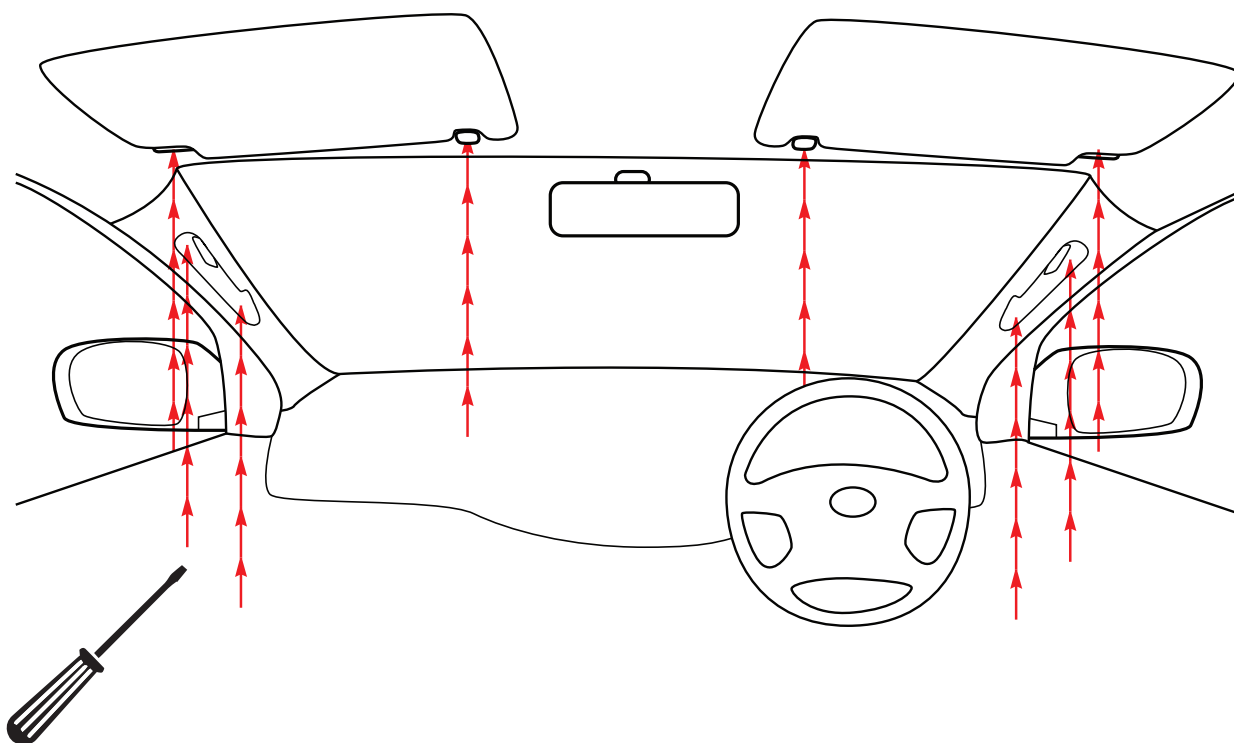

Put roof lining back to its original place.

STEP 9

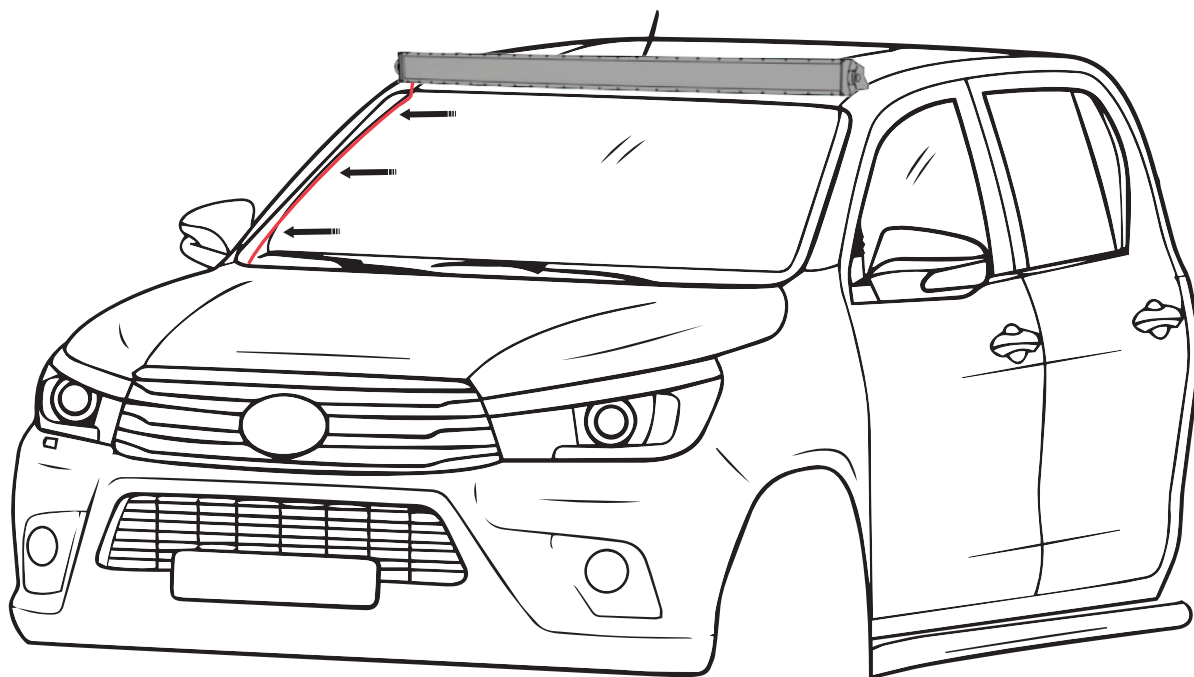

Run the wiring down the side of your windscreen, and reel under bonnet preferably on the same side as the battery. Use a few dabs of silicone or to hold it in place.

Note:

There can be some whistling, and it all depends on your bar also.

Best thing to do if you get wind noise, is either place some hard compound rubber at intervals in the fins along the rear of the bar, that will suppress the vibration caused by the wind compressing under the bar.

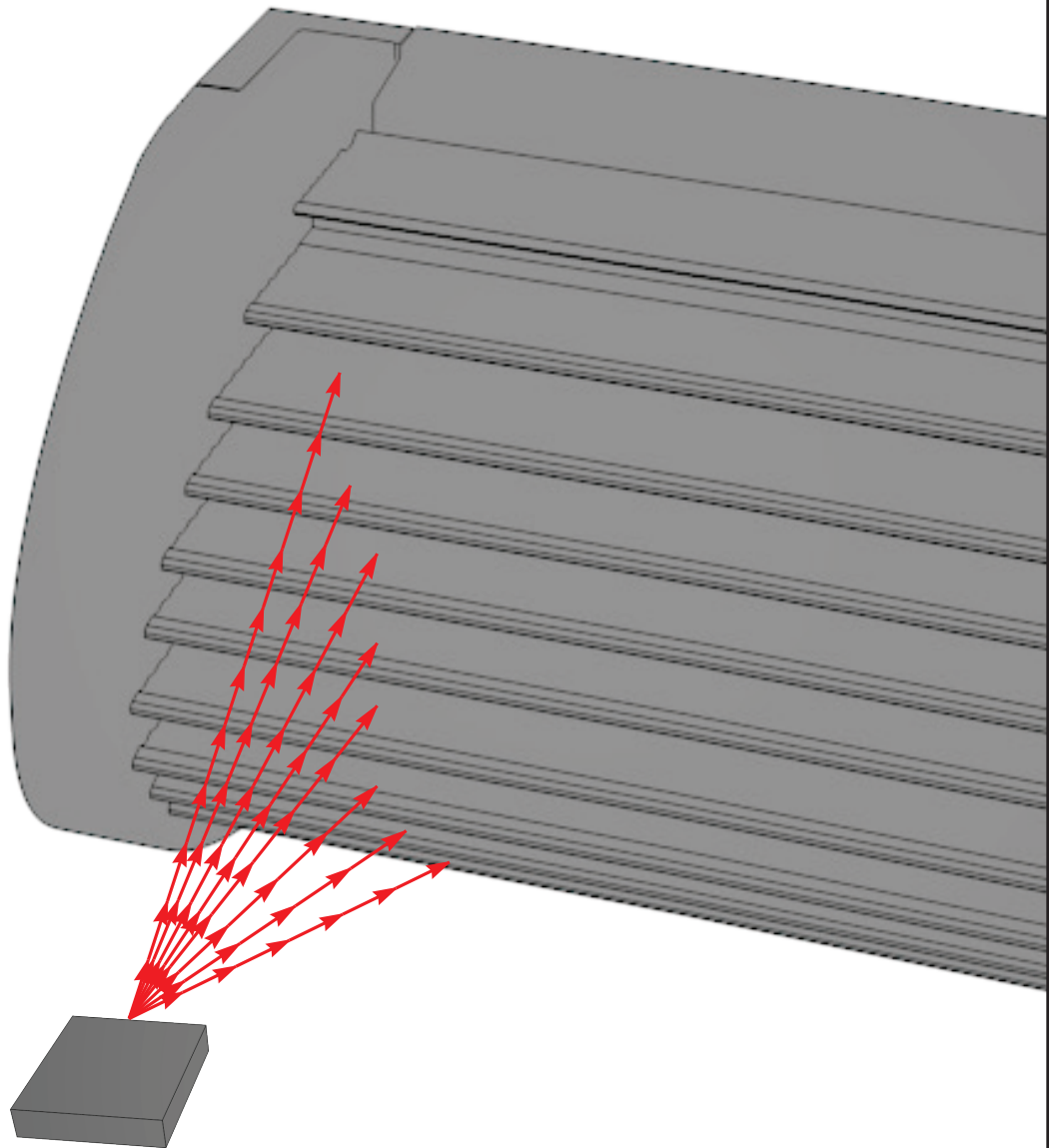

Suggestion:

Fisheye style optics 3D, 4D, 5D are not recommended as they drop light vertically down from the face of the light bar.